

DS-2CD2D21G0(/M)-D/NF

2 MP Indoor Mini Network Camera



Pinhole Model



Covert Model

- 1/2.7" Progressive Scan CMOS
- Up to 1920 x 1080 Resolution @ 30 fps
- H.265+, H.265, H.264+, H.264
- 120dB True WDR
- 3D DNR
- 6 Behavior Analyses, 2 Exception Detections
- 12 VDC, maximum 3 W

The Hikvision DS-2CD2D21G0(/M)-D/NF Indoor Mini Network Camera provides high definition output. It supports H.265+ video compression, which assures savings in bandwidth and storage.

Pinhole and covert models are available, and facilitate surveillance in sensitive situations that require discretion.

Smart features, such as line crossing, intrusion, unattended luggage, and scene change detection are also supported.

Available models:

Pinhole
Covert



Specifications

	DS-2CD2D2160-D/NF	DS-2CD2D2160/M-D/NF
Camera		
Image Sensor	1/2.7" progressive scan CMOS	
Minimum Illumination	Color: 0.025 lux @ (f/1.2, AGC on), 0.109 lux @ (f/2.5, AGC on) B/W: 0.005 lux @ (f/1.2, AGC on), 0.022 lux @ (f/2.5, AGC on)	Color: 0.025 lux @ (f/1.2, AGC on), 0.069 lux @ (f/2.0, AGC on) B/W: 0.005 lux @ (f/1.2, AGC on), 0.014 lux @ (f/2.0, AGC on)
Shutter Speed	1/3 s to 1/100,000 s	
Slow Shutter	Yes	
Auto-Iris	No	
Day/Night	Electronic	
Digital Noise Reduction	3D DNR	
WDR	120dB	
Lens		
Focal length	3.7 mm	2.8 mm, 4 mm
Focus	Fixed	
FOV	3.7 mm: horizontal FOV: 78°, vertical FOV: 43°, diagonal FOV: 90°	2.8 mm: horizontal FOV: 114°, vertical FOV: 62°, diagonal FOV: 135° 4 mm: horizontal FOV: 86°, vertical FOV: 46°, diagonal FOV: 102.5°
Lens Mount	M12	
Compression Standard		
Video Compression	H.265/H.264+/H.264	
H.264 Type	Baseline profile/main profile/high profile	
H.264+	Yes	
H.265 Type	Main profile	
H.265+	Yes	
Video Bit Rate	32 Kbps to 8 Mbps	
Smart Features		
Behavior Analysis	Line crossing detection, intrusion detection, region entrance detection, region exit detection, unattended baggage detection, object removal detection	
Exception Detection	Scene change detection, defocus detection	
Face Detection	Yes	
Region of Interest	Supports one fixed region for main stream and sub-stream	
Image		
Maximum Resolution	1920 × 1080	
Main Stream	30 fps (1920 × 1080, 1280 × 960, 1280 × 720)	
Sub Stream	30 fps (704 × 480, 640 × 480, 352 × 240)	
Third Stream	1 fps (1920 × 1080, 1280 × 960, 1280 × 720, 704 × 480, 640 × 480)	
Image Enhancement	3D DNR	
Image Setting	Rotate mode, saturation, brightness, contrast, sharpness adjustable by client software or web browser	
Day/Night Switch	Day/night/auto/schedule	
Network		
Network Storage	Supports NAS (NFS, SMB/CIFS)	
Alarm Trigger	Motion detection, video tampering, IP address conflict, illegal login	
Protocols	TCP/IP, ICMP, HTTP, HTTPS, FTP, DHCP, DNS, DDNS, RTP, RTSP, RTCP, PPPoE, NTP, UPnP, SMTP, SNMP, IGMP, 802.1X, QoS, IPv6, Bonjour	
General Function	One-key reset, anti-flicker, three streams, heartbeat, password protection, privacy mask, watermark, IP address filter	
API	ONVIF (PROFILE S, PROFILE G), ISAPI	
Simultaneous Live View	Up to 6 channels	
User/Host	Up to 32 users; three levels: administrator, operator and user	
Client	iVMS-4200, iVMS-4500, Hik-Connect	
Web Browser	IE 8+, Chrome 31.0-44, Firefox 30.0-51, Safari 8.0+	
Interface		
Audio	1 input (line in)	
Communication Interface	1-port RJ45 10M/100M self-adaptive Ethernet port	
Reset Button	Yes	
General		
Operating Conditions	-22° F to 140° F (-30° C to 60° C), humidity 95% or less (non-condensing)	
Power Supply	12 VDC ± 25%, Ø 5.5 mm coaxial plug power	
Power Consumption and Current	12 VDC, 0.3 A, maximum 3 W	
Material	Aluminum alloy	
Dimensions	1.2" x 1.2" x 1.5" (31 mm x 31 mm x 39 mm)	1.2" x 1.2" x 1" (31 mm x 31 mm x 26 mm)
Weight	0.2 lbs (0.93 kg)	

Dimensions

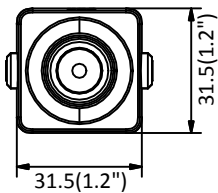

Pinhole Model

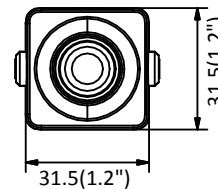
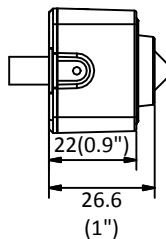

Covert Model

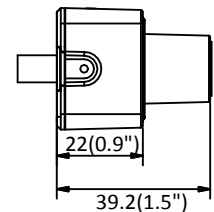

Units: mm (inch)